

WALL SCHEDULE

FLOOR AND ROOF SCHEDULE

NO.	RATING	TYPE	NO.	RATING	TYPE
EW 1	1 HR	2 LAYERS 1/2" TYPE "X" GYP. BD. POLY VAPOUR BARRIER 6" - 20GA. STEEL STUDS @ 16" O.C. R20 BATT INSULATION BUILDING PAPER STUCCO ON K-LATH	F1/EF 1		CERAMIC TILE ON MORTAR BASE/CARPET 4" CONCRETE SLAB VAPOUR BARRIER 6" COMPACT GRAVEL
EW 2		STUCCO ON K-LATH 6" - 20GA. STEEL STUDS @ 16" O.C. STUCCO ON K-LATH	EF2	1 HR	SUSPENDED FIRE RATED T-BAR CEILING ACOUSTIC LAY-IN PANELS 2 X 10 FLOOR JOISTS @ 16" O.C. 3/4" SHIPLAP SUBFLOOR 1/2" T&G FIR FINISHED FLOOR
EW-3	1 HR	PLASTER 8" CONC. BLOCK WALL STUCCO FINISH	EF3	1 HR	5/8" TYPE "X" GYP. BD. (TAPED & FILLED) 2 X 10 JOISTS @ 16" O.C. 3/4" SHIPLAP SUBFLOOR 1/2" T&G FIR FINISHED FLOOR
EW-4	1 HR	STUCCO FINISH OR 3" WOOD SIDING 3/4" SHIPLAP 2X4 STUDS @ 16" O.C. 5/8" TYPE "X" GYP. BD.	ER1	1 HR	2 LAYERS 1/2" TYPE "X" GYP. BD. POLY V.B. 10" - 14GA. STEEL JOISTS @ 16" O.C. R20 BATT INSULATION 1 1/2" STEEL DECK 12" EXTERIOR GRADE GYP. BD. BUILT-UP ROOFING
EW-5	1 HR	STUCCO FINISH 3/4" SHIPLAP 2X4 STUDS @ 16" O.C. PLASTER ON LATH PLASTER ON K-LATH	ER2	1 HR	SUSPENDED T-BAR CEILING ACOUSTIC LAY-IN (FIRE RATED) PANELS 2 X 4 RAFTERS @ 24" O.C. 1 X 4 STRAPPING @ 8" O.C. CEDAR SHINGLES ASPHALT SHINGLES ON SLOPING ROOF
EW-6	1 HR	5/8" TYPE "X" GYP. BD. BOTH SIDES 2X4 STUDS @ 16" O.C.	ER3	1 HR	SUSPENDED T-BAR CEILING ACOUSTIC LAY-IN (FIRE RATED) PANELS 5/8" TYPE "X" GYP. BD. (TAPED & FILLED) 2 X 10 JOISTS @ 16" O.C. 3/4" PLYWOOD SHEATHING R20 BATT INSULATION BUILT-UP ROOFING
W7		1/2" GYP. BD. BOTH SIDES 2X4 STUDS @ 16" O.C.			

NOTE: "E" PREFIX INDICATES EXISTING

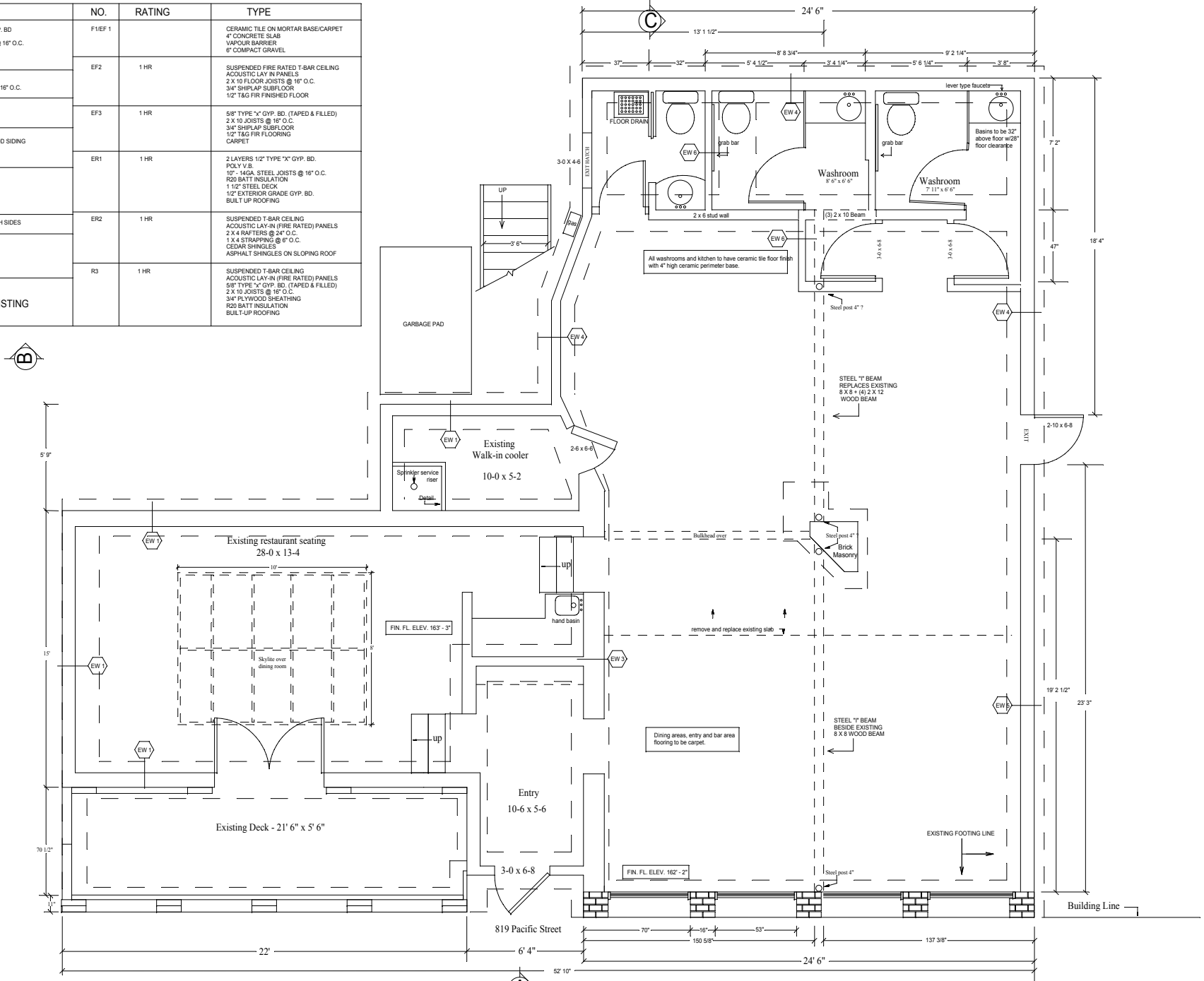

MAIN FLOOR PLAN - PROPOSED